

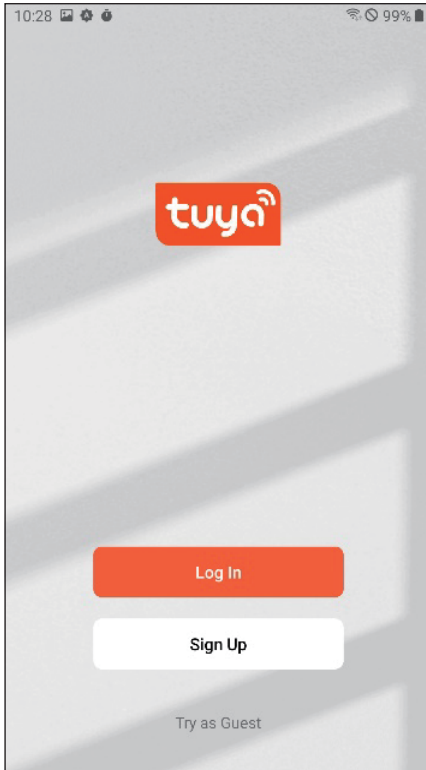

Tuya_General App. User Manual

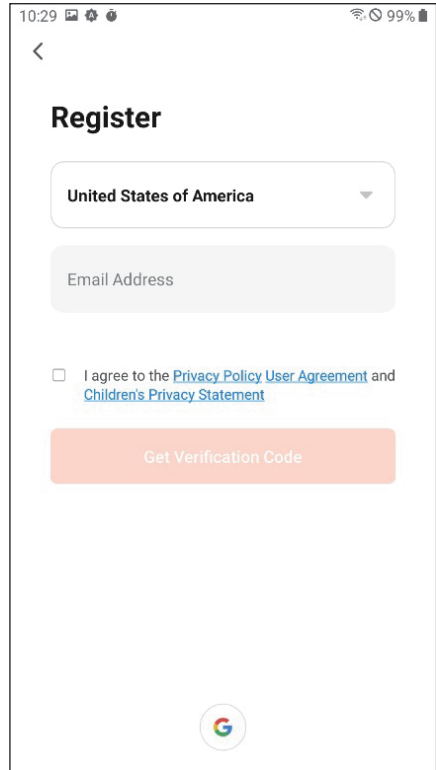

Sign up



Enter the email address to use, agree to the Privacy policy, and get the verification code.

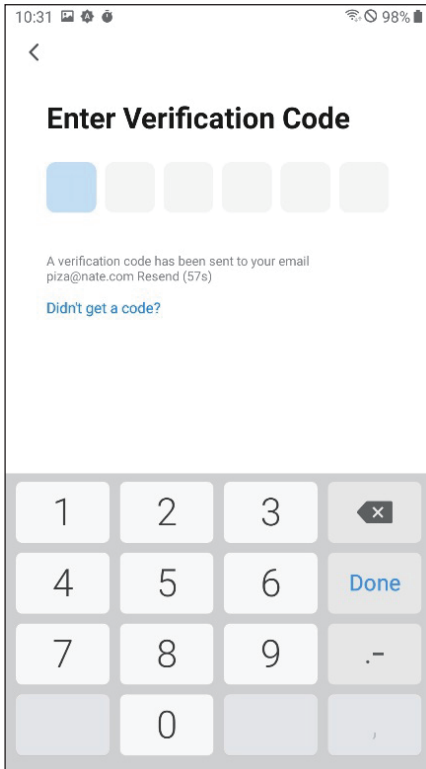

Enter the verification code.

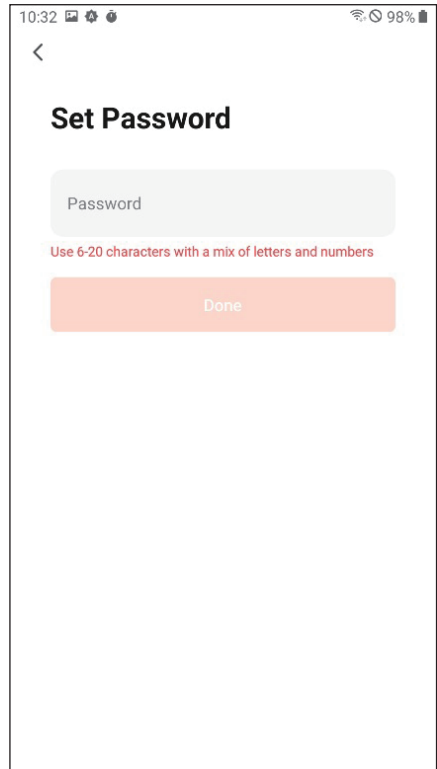

Enter the password to use and click 'Done.'

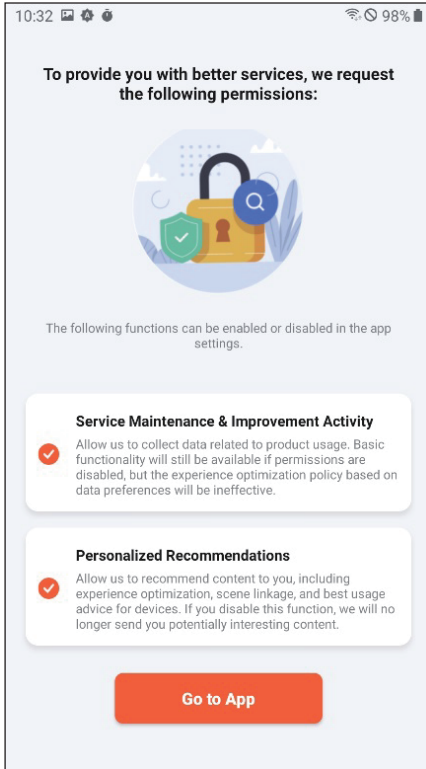

After confirming permissions, click 'Go to App'

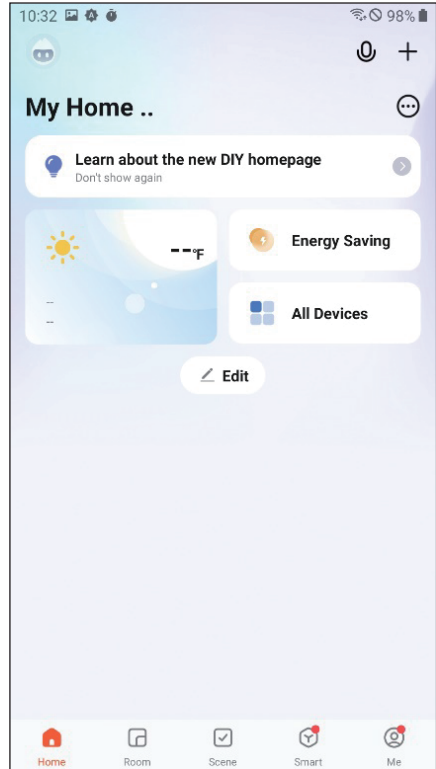

Sign up and Log in completed.

12V
Adaptor is mandatory

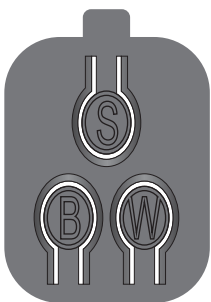

Press W button on the back side of the door after open the door.



Pair

Pair and  icon will blink on the display

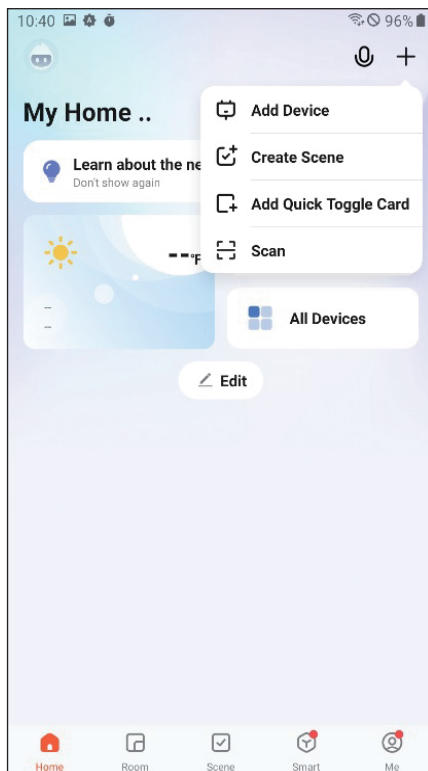

Click ADD DEVICE on the TUYA App.

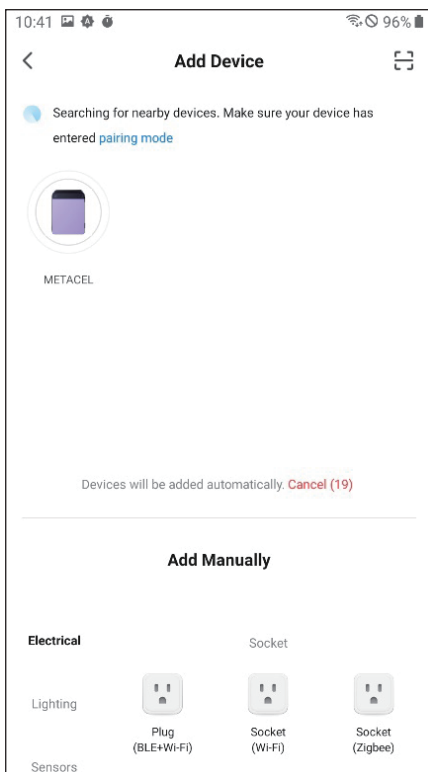

Click METACEL icon on the TUYA App.

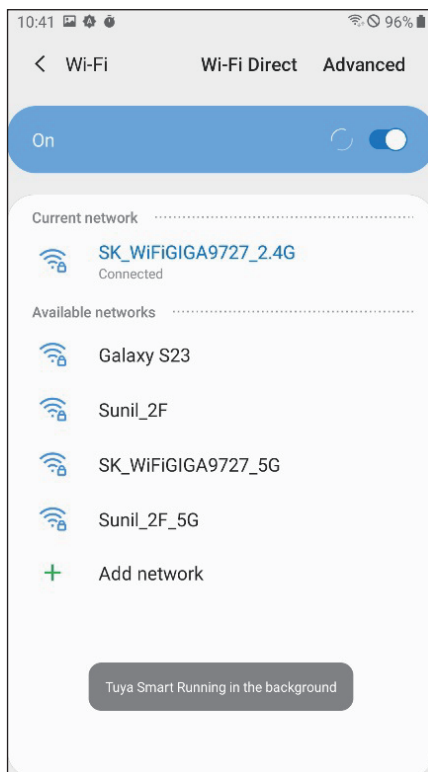

Select WiFi to connect

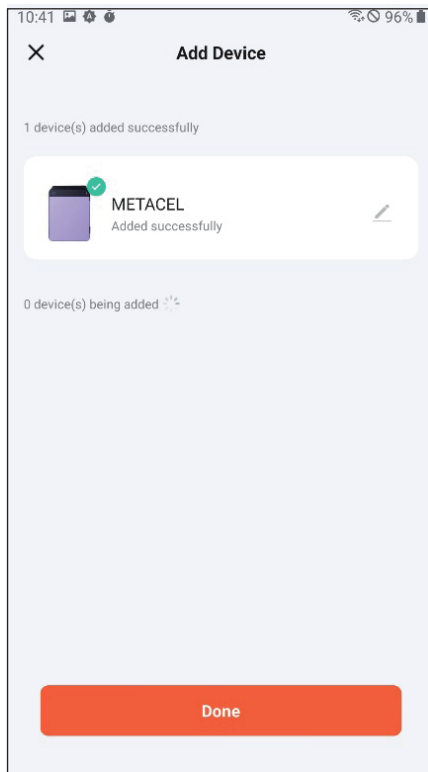
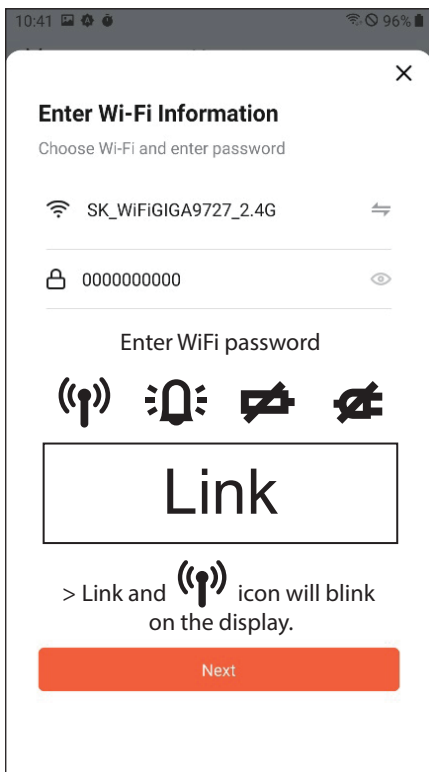

Pairing completed.

- Non-con will be displayed when password is wrong or WiFi signal is weak.
- Possible to connect only to WiFi 2.4GHz. Not allowed to connect WiFi 5GHz

Press START button



Press '0' button for 3 seconds



Numeric keypad blinks

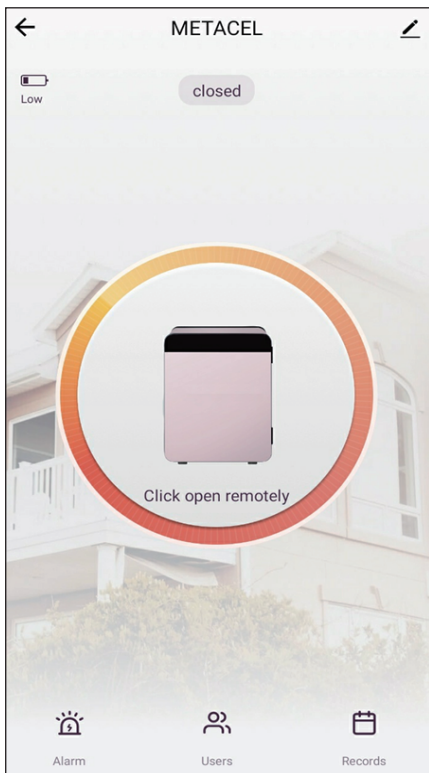

Click icon of safe on the TUYA App.

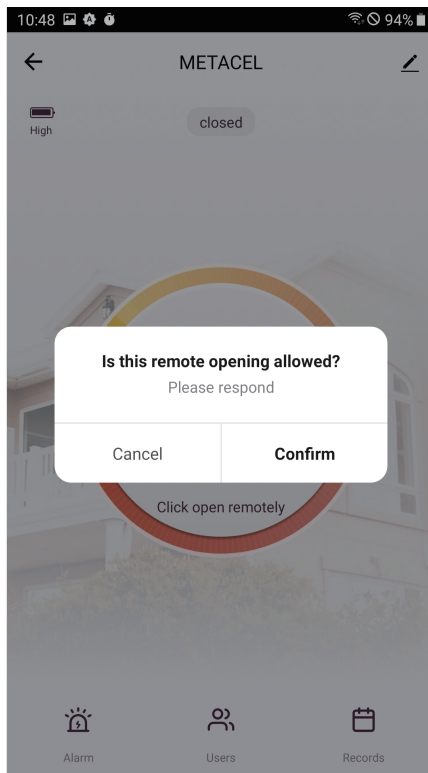

Click YES to confirm remote open, click NO to reject remote open.

- This function can be done when the door is closed.
- Activate TUYA Smart App before doing remote open. (30seconds without response will lead to Time Out.)
- No alarm when remote open is requested.